



T601-2

Pro1 Technologies, Inc.

1111 S. Glenstone Ave., Suite 2-100
Springfield, MO 65804

Toll-Free: 888-776-1427 **Web:** www.pro1iaq.com

Hours of Operation: M-F 9AM - 6PM Eastern

Table of Contents	Page
Thermostat Quick Reference	2
Thermostat Operation	3
Warranty Registration	4



Caution:

Equipment damage hazard
Do not operate the cooling system if the outdoor temperature is below 50 ° F (10° C) to prevent possible compressor damage.

Una versión en español de este manual se puede descargar en la página web de la compañía.

OPERATING MANUAL

THERMOSTAT QUICK REFERENCE

Getting to know your thermostat

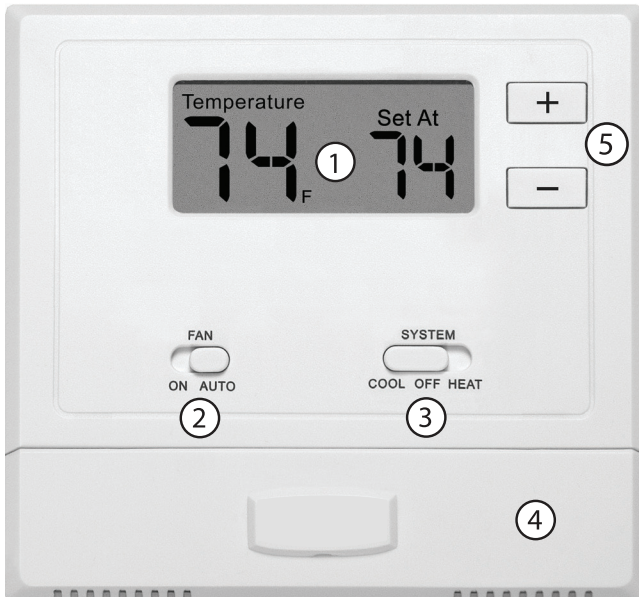

- ② Fan Switch
- ③ System Switch
- ④ Easy Change Battery Door
- ⑤ Setpoint Buttons

① LCD

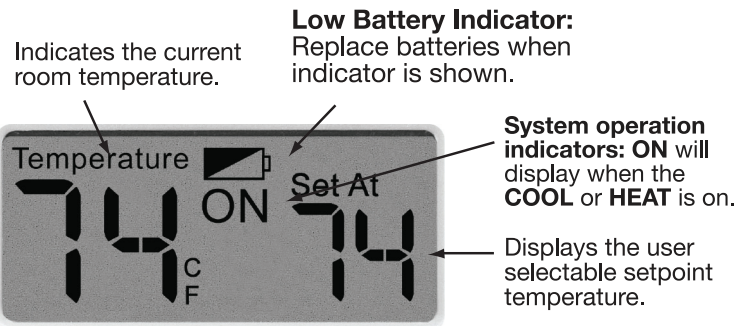

Important:

The low battery indicator is displayed when the AA battery power is low. If the user fails to replace the battery within 21 days, the thermostat display will only show the low battery indicator as a final warning before the thermostat becomes inoperable.

Battery door information

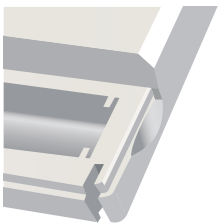

Use the finger bevel on the lower portion of the side of the thermostat to open the easy access battery door.

Replace with 2 AA Alkaline batteries. High Quality Alkaline batteries are recommended

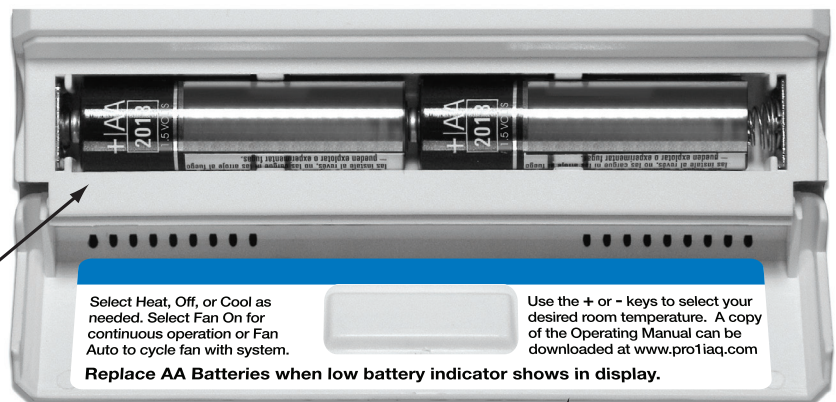

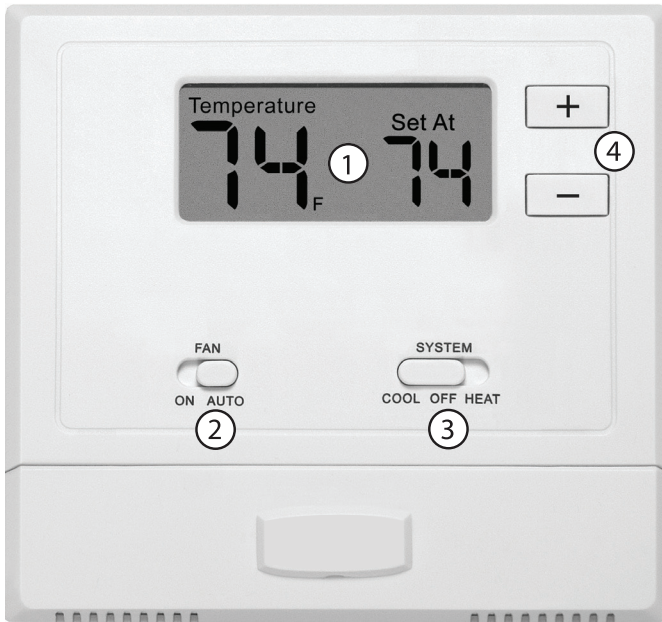

Simple operating instructions are found on the back of the battery door.

Easy to use controls



Caution:

When the battery icon  appears replace your AA batteries immediately. Failure to do so may result in your heating & cooling system becoming inoperable.

- ① **LCD Display:**
See page 2 for details about this display read out.
- ② **Fan Switch:**
Select ON or AUTO . ON will run the fan continuously. AUTO will cycle the fan on only when the heating or cooling system is on.
- ③ **System Switch:**
Selects the operation mode of your HVAC system. Selecting HEAT turns on the heat mode. Selecting COOL turns on the air conditioning mode. Selecting OFF turns both heating and cooling off.
- ④ **Temperature Setpoint Buttons:**
Press the  or  buttons to select the desired room temperature.

Warranty Registration:

Your new thermostat has a 5 year limited warranty. You must register your warranty within 60 days of installation. You can register your new thermostat in 2 ways.

- ① Go to our website, select warranty registration and fill out a short registration form.
- or -
- ② Complete the form below and mail it to the address shown.



Warranty Registration:

Name: _____

Address: _____

City: _____

State: _____

Zip: _____

Thermostat Model: _____

Date Installed: _____

Complete form and mail to:

Thermostat Warranty Registration

1111 S. Glenstone

Suite 2-100

Springfield, MO 65804